

# Kids Footpedal Sanitiser

The JG3 hand sanitiser dispenser is foot-pedal operated so there is no hand contact at all, minimising the risk of contamination. It is also 100% mechanical, so there are no battery or electrical requirements, meaning it is cheaper to run and better for the environment. Built for kids with a reduced height of 800mm. It's everything our 'big' sanitisers are with the same bottle capacity, just shorter!

The JG3 is available in 4 kid-friendly colours and is built to last with its quality, steel construction. Refill the reusable bottles with any sanitiser, no special refills, subscriptions or contracts.

## Product Dimensions:

Diameter 115mm post, 800mm high. Round base plate 250mm. Adjustable height inside for different sized sanitiser bottles.

## Material and Finish:

Main body: Mild steel polyester powder coated Lid and Footpedal: Stainless steel grade 304, satin polished finish.

## Colour Options (semi gloss finish):

RAL1018: Zinc yellow  RAL3020: Signal red  RAL6018: Green  RAL5015: Sky Blue 

## Fixing Method:

Free standing. Product can be bolted to the ground using M8 ground anchors (bolts available as an optional extra)

## Delivery Details:

Weight: 6kg. Box Dimensions: 950x260x260mm  
Pack includes one assembled unit, two 1.1ltr bottles, one nozzle and 1 cap for bottle hot-swapping. Refill bottles made from 100% recycled plastics.

## Usage:

Place hands under nozzle and press the foot pedal to dispense the sanitiser.

## Replacing the bottle:

- Undo the fixing bolt of the lid with 4mm allen Key, remove lid of dispenser and bottle as shown on fig.1
- Refill bottle and insert it back in place. Alternatively hot swap bottle for new one placing the neck plate on before screwing the nozzle.
- Slot lid back on dispenser and secure it using the allen key, making sure the nozzle sits under the protrusion on the lid.

## Adjusting height for different sanitiser bottles:

- Remove lid and bottle as above and extract the bottle plinth as shown in fig 2.
- Adjust the height by loosening the locking nut and twisting thread rod to the desired height.
- Once the correct height is reached, tighten the locking nut and slide back inside the main body.
- Place new bottle in place and ensure neck plate is fitted and the nozzle sits under the protrusion on the lid.

## Maintenance:

In order to maintain a "factory finish", steel may require an ongoing cleaning regime, the extent and frequency of which depends on the environment in which the product is placed. Wipe down the product with water and detergent or specialist cleaning agents if deposits are embedded.

**End of Life:** the entire unit including refillable bottles and nozzle can be recycled with zero to landfill.

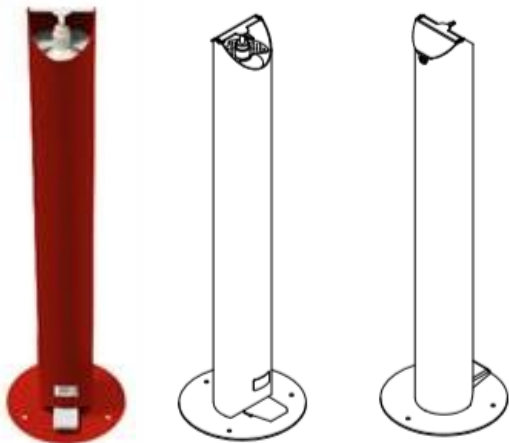

Fig. 1: Bottle replacement:

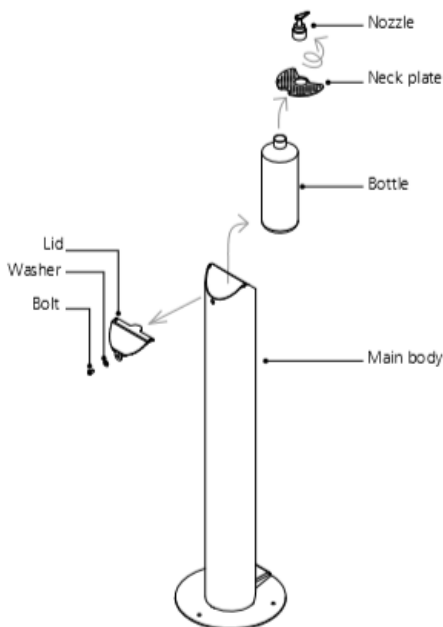

Fig. 2: Height adjustment

